



Since
1948
JAPANESE
INNOVATION



PRELIMINARY II

2013 CAR AUDIO

www.nakamichicaraudio.com



AV HEAD UNITS

**5.1 CH
DSP Audio**



Audio Zone Time Alignment

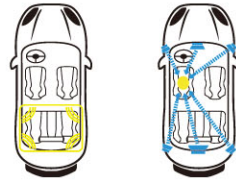

X-Bass Master

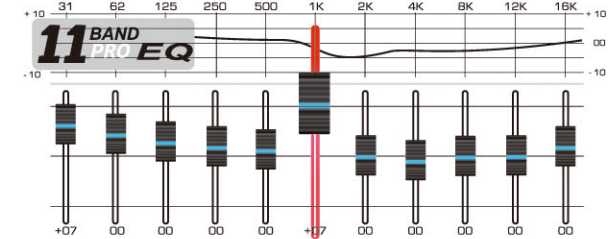

GPS Ready

5V PREOUTS X5

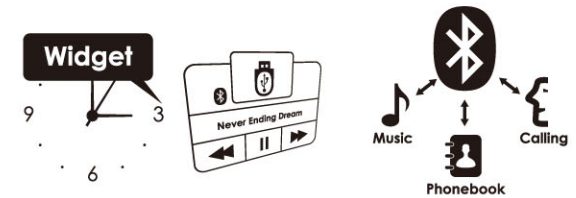

Gesture Control



Live Wallpaper

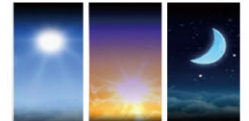

**High resolution
WVGA Touch TFT**

Multi-Languages OSD

Nakamichi®



11 BAND PRESENT EQ



AV HEAD UNITS

Bringing you Smart Phone user experience

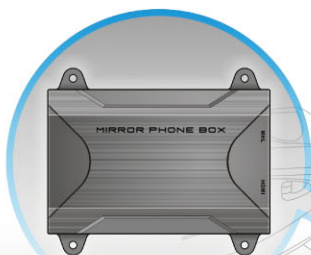

- Mirror your Smart Phone to AV screen
- 2 way Touch screen control
- Supports most of Android Smart Phone in the markets
- Supports iPhone 4 / iPhone 4S / iPhone 5 (Mirror only, not supports 2 way control)

Mirror Ready Models:



MHL

HDMI

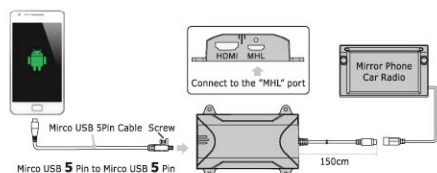

✓ Mirco USB Cable included.

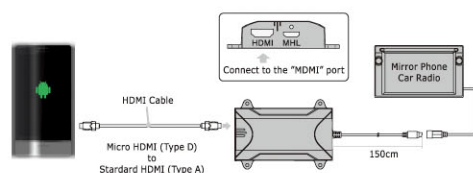

✗ HDMI Cable not included. ✗

MHL (SAMSUNG GALAXY S III / Note II)

HDMI (iPhone4 / 4S / iPhone 5)

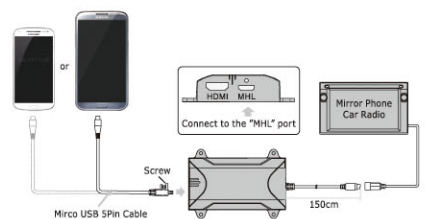

Mirco USB 11 Pin to Mirco USB 5 Pin



✓ Mirco USB Cable included.

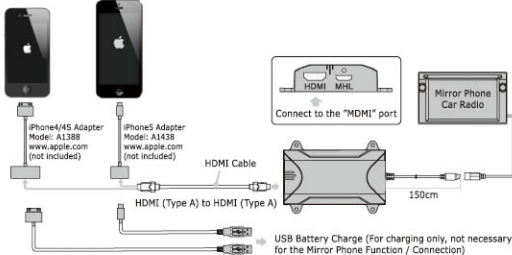

USB Battery Charge (For charging only, not necessary for the Mirror Phone Function / Connection)

✗ HDMI Cable & Apple adaptor not included. ✗



NA2750 Multimedia DVD/CD/USB/SD Receiver with Touch Panel Monitor



7" Touch TFT

32K Variable Color Illumination



NA1850 Multimedia DVD/CD/USB/SD Receiver with 7" In-Dash Widescreen Touch Panel Monitor



RECEIVERS



6.2" Touch TFT



NA2650

Multimedia DVD/CD/USB/SD Receiver with Touch Panel Monitor



6.2" Touch TFT



NA1550

Multimedia DVD/CD/USB/SD Receiver with Touch Panel Monitor



NA1650

Multimedia DVD/CD/USB/SD Receiver with Touch Panel Monitor



NA130

DVD/USB/SD Receiver



RECEIVERS

NA350iBTR

CD/USB/SD Receiver

5V Front & rear PRESETS iPhone iPod USB Bluetooth



NA300iR

CD/USB/SD Receiver

5V Front & rear PRESETS iPhone iPod USB

32K Variable Color Illumination

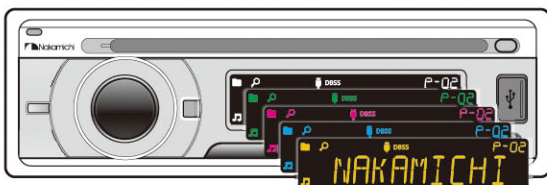

NA250BTR

CD/USB/SD Receiver

5V Front & rear PRESETS Bluetooth

NA200R

CD/USB/SD Receiver

5V Front & rear PRESETS

Titanium Chassis 4 MOSFET x50W XBASS (DBSS) 8 PRESET EQ IR REMOTE Detachable Panel QUICK MUSIC FILE BROWSER 11 LCD ESP 32K Variable Color Illumination SUB PRESET CONTROL R-D-S MP3 FRONT USB SD FRONT AUX

NA788

2-DIN CD/USB/SD Receiver

32K Variable Color Illumination 2nd Battery Charge USB 1A 4V Front & rear PRESETS Bluetooth iPhone iPod USB Titanium Chassis 4 MOSFET x50W R-D-S SD FRONT USB MP3 FRONT AUX 3 BAND PRO EQ 6 PRESET EQ XBASS QUICK MUSIC FILE BROWSER FM/AM LPF SUBW SOURCE EQ External Microphone IR REMOTE

NA780

2-DIN CD/USB/SD Receiver

2nd Battery Charge USB 1A 4 MOSFET x50W Rear Preamp Line Out FRONT USB MP3 FRONT AUX 3 BAND PRO EQ 6 PRESET EQ SD XBASS QUICK MUSIC FILE BROWSER FM/AM LPF SUBW IR REMOTE

NA100R

CD/USB Receiver



Titanium Chassis 4 MOSFET x50W XBASS (DBSS) 8 PRESET EQ IR REMOTE Detachable Panel QUICK MUSIC FILE BROWSER 8 LCD ESP R-D-S SUB PRESET CONTROL 3V PRESETS MP3 FRONT USB FRONT AUX

NA400

DVD/CD/USB Receiver



4 MOSFET x50W XBASS (DBSS) 8 PRESET EQ IR REMOTE Detachable Panel QUICK MUSIC FILE BROWSER 8 LCD 3V Front & rear PRESETS ESP SUB PRESET CONTROL DVD MP3 FRONT USB FRONT AUX

RECEIVERS

APPS RADIO

NA708, NA88

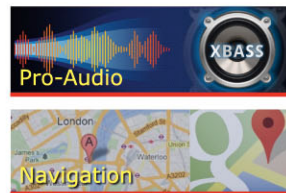
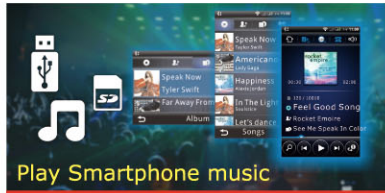

NA99i
CD/USB Receiver

NA98s
CD/USB Receiver

NA98
CD/USB Receiver



NA708
2-DIN USB/SD Receiver



NA88
USB/SD Receiver



NA85
USB/SD Receiver



NA80
USB/SD Receiver



NGT-SERIES_AMPLIFIERS



NGTD1200.1

Digital Mono-block Power Amplifier

8000W
peak power

RMS 400Wx1 @ 4Ω
RMS 800Wx1 @ 2Ω
RMS 1200Wx1 @ 1Ω

Class-D Mono channel

NGTA704

Bridgeable 4-channel Power Amplifier

4500W
peak power

RMS 60Wx4 @ 4Ω
RMS 90Wx4 @ 2Ω
RMS 180Wx2 @ 4Ω(Bridged)

Class-A/B 4/3/2 channel

NGTD600.1

Digital Mono-block Power Amplifier

6000W
peak power

RMS 300Wx1 @ 4Ω
RMS 500Wx1 @ 2Ω
RMS 600Wx1 @ 1Ω

Class-D Mono channel

NGTA602

Bridgeable 2-channel Power Amplifier

2500W
peak power

RMS 60Wx2 @ 4Ω
RMS 90Wx2 @ 2Ω
RMS 180Wx1 @ 4Ω(Bridged)

Class-A/B 2/1 channel

- ▼ The NGTD series use high quality two-side layer PCB
- ▼ The NGTA series use high quality one layer PCB
- ▼ Uniquely designed high efficient power transformer
- ▼ Power supply switching FET
- ▼ NGTA series have High pass / Low pass / Full range switching function
- ▼ Highly quality deluxe guage input RCA and deluxe guage power terminal connector
- ▼ Power and protect indicators

NGTD4

Digital 4-channel Power Amplifier

1000W
peak power

RMS 50Wx4 @ 4Ω

Class-D 4/3/2 channel

NGTD1

Digital Mono-block Power Amplifier

1000W
peak power

RMS 200Wx1 @ 4Ω
RMS 300Wx1 @ 2Ω

Class-D Mono channel

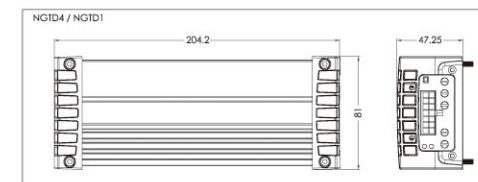
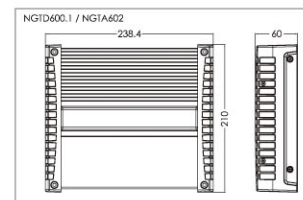
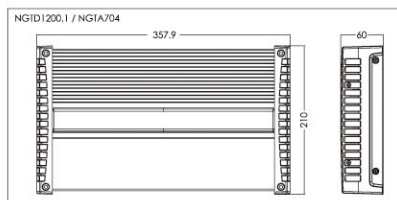

P-SERIES_AMPLIFIERS



PM-1500.1

Digital Mono-block Power Amplifier

4500W
peak power

RMS 500Wx1 @ 4Ω
RMS 1000Wx1 @ 2Ω

Class-D

Mono channel

PM-750.1

Digital Mono-block Power Amplifier

3000W
peak power

RMS 350Wx1 @ 4Ω
RMS 750Wx1 @ 2Ω

Class-D

Mono channel

PM-360.4

Bridgeable 4-channel Power Amplifier

2200W
peak power

RMS 90Wx4 @ 4Ω
RMS 100Wx4 @ 2Ω
RMS 150Wx2 @ 4Ω[Bridged]

Class-A/B

4/3/2 channel

PL-475

Bridgeable 4-channel Power Amplifier

1800W
peak power

RMS 75Wx4 @ 4Ω
RMS 100Wx4 @ 2Ω
RMS 180Wx2 @ 4Ω[Bridged]

Class-A/B

4/3/2 channel

PL-290

Bridgeable 2-channel Power Amplifier

1200W
peak power

RMS 90Wx2 @ 4Ω
RMS 150Wx2 @ 2Ω
RMS 210Wx1 @ 4Ω[Bridged]

Class-A/B

2/1 channel

- ▼ Use high quality one Layer PCB
- ▼ Uniquely designed high efficient power transformer
- ▼ Power supply switching FET
- ▼ High pass / Low pass / Full range switching function
- ▼ Highly quality deluxe guage input RCA and deluxe guage power terminal connector
- ▼ Power and protect indicators



- ▼ PM-750.1 use high quality one layer PCB
- ▼ PM-1500.1 & PM-360.4 use high quality two-side layer PCB
- ▼ Uniquely designed high efficient power transformer
- ▼ Power supply switching FET
- ▼ Highly quality deluxe guage input RCA and deluxe guage power terminal connector
- ▼ Bass boost control
- ▼ Power and protect indicators

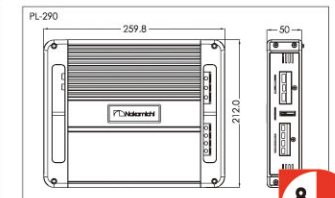
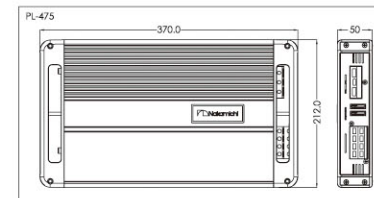
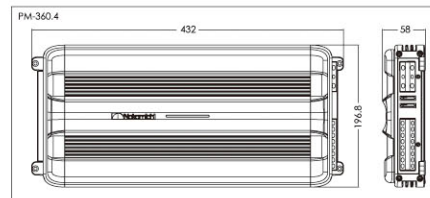
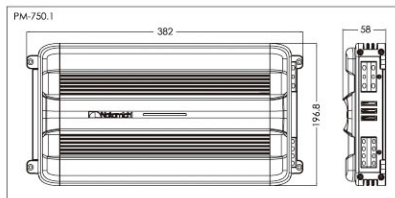
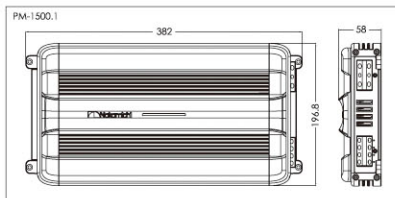

SP-SERIES_SPEAKERS



SP-W3500D

12" (30cm) DVC Subwoofer Unit

3000W
peak power

4ohms + 4ohms

20Hz ~ 1500Hz

450W RMS

High Density Foam Surround

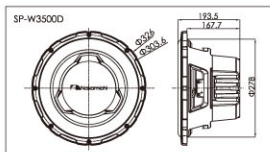

SP-W350D

12" (30cm) DVC Subwoofer Unit

2500W
peak power

4ohms + 4ohms

25Hz ~ 1500Hz

350W RMS

High Density Foam Surround

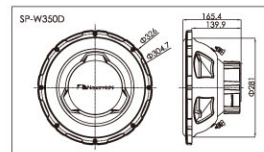

SP-CS680

6.5" (16.5cm) 2-way Component Speaker

480W
peak power

4ohms

60Hz ~ 20kHz

50W RMS

Rubber Surround

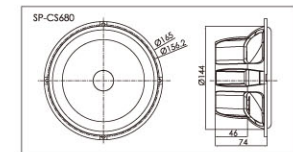

SP-SERIES_SPEAKERS



SP-CS68s

6.5" (16.5cm) 2-way Component Speaker

420W	4ohms
peak power	50Hz ~ 22kHz
45W RMS	Rubber Surround

SP-S7080

7x10" (18x25cm) 3-way Coaxial Speaker

720W	4ohms
peak power	40Hz ~ 20kHz
90W RMS	Rubber Surround

SP-S6980

6x9" (15x23cm) 3-way Coaxial Speaker

600W	4ohms
peak power	45Hz ~ 20kHz
80W RMS	Rubber Surround

SP-S1630

6.5" (16.5cm) 3-way Coaxial Speaker

420W	4ohms
peak power	50Hz ~ 22kHz
40W RMS	Rubber Surround

SP-T25

25mm KSV Tweeter System

150W	4ohms
peak power	1500Hz ~ 20kHz
15W RMS	25mm KSV Voice Coil

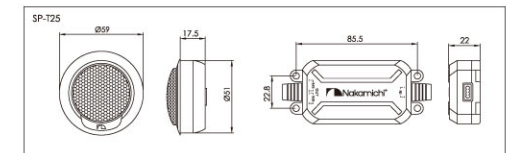
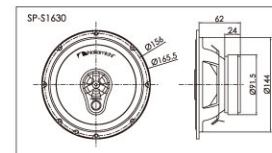
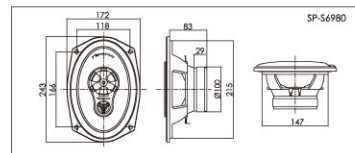
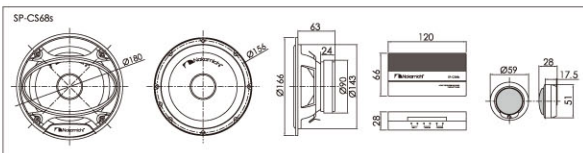

N-SERIES_SPEAKERS



NG 112

12" (30cm) DVC Subwoofer Unit

2000W	4ohms + 4ohms
peak power	40Hz ~ 1000Hz
250W RMS	High Density Foam Surround

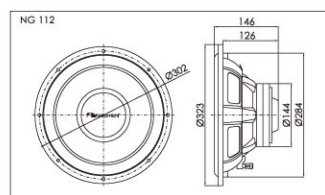

NSE 60

6.5" (16.5cm) 2-way Component Speaker

450W	4ohms
peak power	80Hz ~ 20kHz
30W RMS	Rubber Surround

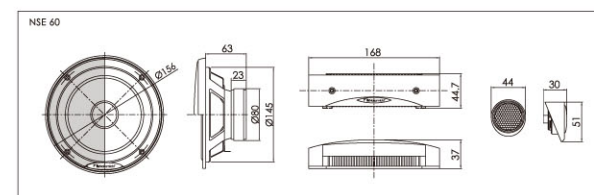

N-SERIES_SPEAKERS

NSE 963

6x9" (15x23cm) 3-way Coaxial Speaker

660W peak power	4ohms
80W RMS	45Hz ~ 20kHz
	Rubber Surround

NSE 953

6x9" (15x23cm) 3-way Coaxial Speaker

500W peak power	4ohms
35W RMS	60Hz ~ 20kHz
	Rubber Surround

NSE 952

6x9" (15x23cm) 2-way Coaxial Speaker

420W peak power	4ohms
25W RMS	60Hz ~ 20kHz
	Rubber Surround

NSE 76

6.5" (16.5cm) 2-way Coaxial Speaker

420W peak power	4ohms
40W RMS	80Hz ~ 20kHz
	Rubber Surround

NSE 65

6.5" (16.5cm) 2-way Coaxial Speaker

380W peak power	4ohms
25W RMS	70Hz ~ 22kHz
	Rubber Surround

NSE 66

6" (16cm) 2-way Coaxial Speaker

380W peak power	4ohms
25W RMS	82Hz ~ 20kHz
	Rubber Surround

NSE 55

5.25" (13cm) 2-way Coaxial Speaker

360W peak power	4ohms
20W RMS	80Hz ~ 20kHz
	Rubber Surround

NSE 45

4" (10cm) 2-way Coaxial Speaker

350W peak power	4ohms
15W RMS	100Hz ~ 20kHz
	Rubber Surround

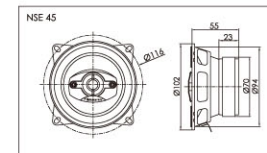
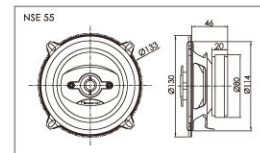
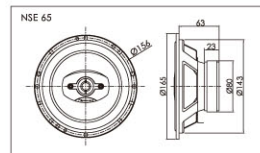
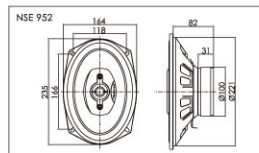
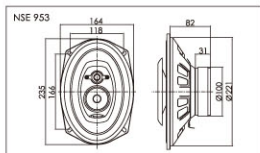
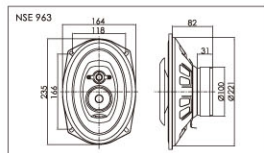

SP-SERIES_SPEAKERS



SP-W31D

12"(30cm) DVC Subwoofer Unit

2500W peak power	4ohms + 4ohms
300W RMS	30.5Hz ~ 1000Hz
	Rubber Surround

SP-W30S

12"(30cm) SVC Subwoofer Unit

1500W peak power	4ohms
200W RMS	27.5Hz ~ 1000Hz
	Rubber Surround

SP-W25S

10"(25cm) SVC Subwoofer Unit

1000W peak power	4ohms
150W RMS	36Hz ~ 1500Hz
	Rubber Surround

SP-CS63

6"(16cm) 2-way Component Speaker

320W peak power	4ohms
30W RMS	70Hz ~ 22kHz
	Rubber Surround

SP-C5

5-way Center Speaker

120W peak power	4ohms
15W RMS	350Hz ~ 20kHz
	5-way

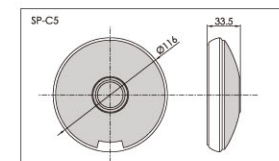
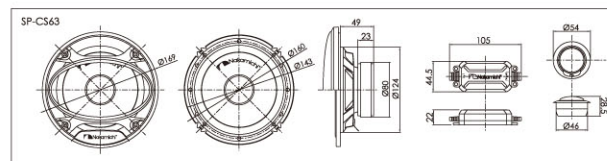
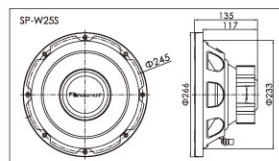
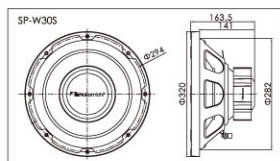
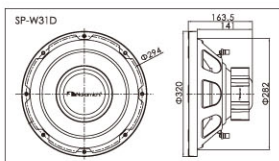

SP-SERIES_SPEAKERS



SP-S6920

6x9" (15x23cm) 2-way Coaxial Speaker

360W peak power	4ohms
30W RMS	50Hz ~ 20kHz
	Rubber Surround

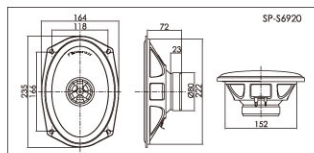

SP-S1620

6.5" (16.5cm) 2-way Coaxial Speaker

300W peak power	4ohms
30W RMS	50Hz ~ 22kHz
	Rubber Surround

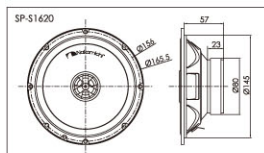

SP-S1320

5.25" (13cm) 2-way Coaxial Speaker

250W peak power	4ohms
25W RMS	80Hz ~ 22kHz
	Rubber Surround

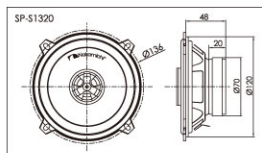

SP-S1020

4" (10cm) 2-way Coaxial Speaker

210W peak power	4ohms
20W RMS	95Hz ~ 22kHz
	Rubber Surround

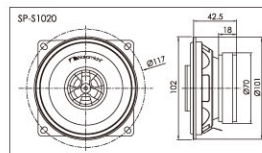

SP-T13

13mm KSV Tweeter System

100W peak power	4ohms
10W RMS	3000Hz ~ 25kHz
	13mm KSV Voice Coil

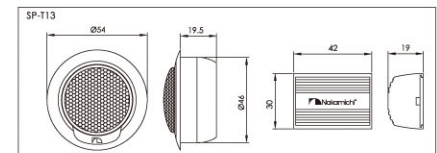

NB-SERIES_BASS TUBES / TUNNEL TUBES

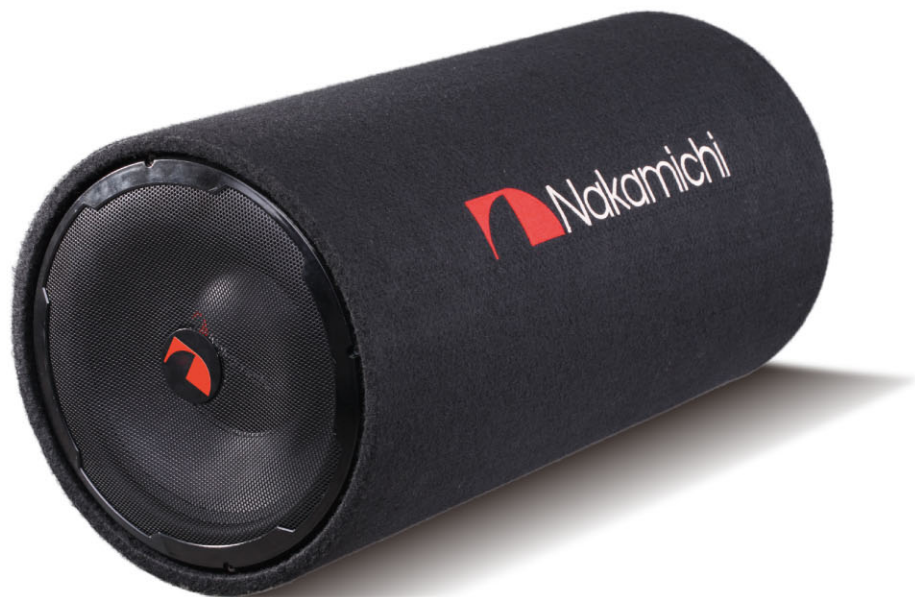

NBT120

12"(30cm) Bass Tube
Car Audio Bass-reflex Subwoofer Tube

1800W peak power	4ohms
300W RMS	33Hz ~ 800Hz
	Magnet 66.8 oz

NBT100

10"(25cm) Bass Tube
Car Audio Bass-reflex Subwoofer Tube

1200W peak power	4ohms
200W RMS	40Hz ~ 2000Hz
	Magnet 32.7 oz

NBT12A

12"(30cm) Active Tunnel Tube
Car Audio Bass-reflex Subwoofer Tube

1200W peak power	4ohms
120W RMS	58Hz ~ 1000Hz
	92 ± 2 dB

NBT10A

10"(25cm) Active Tunnel Tube
Car Audio Bass-reflex Subwoofer Tube

1000W peak power	4ohms
100W RMS	55Hz ~ 1200Hz
	91 ± 2 dB

NBT8A

8"(20cm) Active Tunnel Tube
Car Audio Bass-reflex Subwoofer Tube

800W peak power	4ohms
80W RMS	52Hz ~ 1600Hz
	90 ± 2 dB

Model	Size	L	H
NBT120		26.0" (660mm)	13.2" (335mm)
NBT100		23.6" (600mm)	11.4" (290mm)

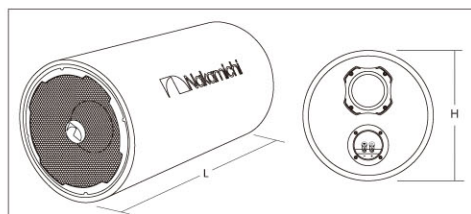

Model	Size	L	W	H
NBT12A		18.9" (480mm)	13.4" (340mm)	13.8" (350mm)
NBT10A		18.9" (480mm)	11.2" (285mm)	12.0" (305mm)
NBT8A		18.9" (480mm)	9.4" (240mm)	10.0" (255mm)

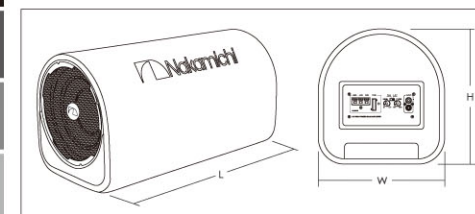

WIRE KITS / ROLL CABLES

NWK44

4

Gauge

4 channel

- ▼ 5.2M matt blue power cable, wiring terminal at one end, 0.12CCA \times 28 \times 7 \times 7+[0.15TC \times 10 \times 12+0.15 \times 10 \times 12], OD:10mm
- ▼ 0.9M matt black ground cable, wiring terminal at one end, 0.12CCA \times 28 \times 7 \times 7+[0.15TC \times 10 \times 12+0.15 \times 10 \times 12], OD:10mm
- ▼ 5.2M \times 2 wine red RCA cable(OFC), [0.12 \times 2 \times 2+foil] \times 2, OD:4+4mm
- ▼ 5.2M matt blue remote cable, 0.15TCA \times 29, OD:2mm
- ▼ Fuse 150A
- ▼ Other accessories



NWK48

8

Gauge

4 channel

- ▼ 5.2M matt blue power cable, wiring terminal at one end, 0.12CCA \times 63 \times 7+[0.15TC \times 8 \times 8+0.15 \times 8 \times 8], OD:6.5mm
- ▼ 0.9M matt black ground cable wiring terminal at one end, 0.12CCA \times 63 \times 7+[0.15TC \times 8 \times 8+0.15 \times 8 \times 8], OD:6.5mm
- ▼ 5.2M \times 2 wine red RCA cable(OFC), [0.12 \times 2 \times 2+foil] \times 2, OD:4+4mm
- ▼ 5.2M matt blue remote wire, 0.15TCA \times 29, OD:2mm
- ▼ Fuse 80A
- ▼ Other accessories

NWK24

4

Gauge

2 channel

- ▼ 5.2M matt blue power cable, wiring terminal at one end, 0.12CCA \times 28 \times 7 \times 7+[0.15TC \times 10 \times 12+0.15 \times 10 \times 12], OD:10mm
- ▼ 0.9M matt black ground cable, wiring terminal at one end, 0.12CCA \times 28 \times 7 \times 7+[0.15TC \times 10 \times 12+0.15 \times 10 \times 12], OD:10mm
- ▼ 5.2M wine red RCA cable(OFC), [0.12 \times 2 \times 2+foil] \times 2, OD:4+4mm
- ▼ 5.2M matt blue remote wire, 0.15TCA \times 29, OD:2mm
- ▼ Fuse 150A
- ▼ Other accessories

NWK28

8

Gauge

2 channel

- ▼ 5.2M matt blue power cable, wiring terminal at one end, 0.12CCA \times 63 \times 7+[0.15TC \times 8 \times 8+0.15 \times 8 \times 8], OD:6.5mm
- ▼ 0.9M matt black ground cable, wiring terminal at one end, 0.12CCA \times 63 \times 7+[0.15TC \times 8 \times 8+0.15 \times 8 \times 8], OD:6.5mm
- ▼ 5.2M wine red RCA cable(OFC), [0.12 \times 2 \times 2+foil] \times 2, OD:4+4mm
- ▼ 5.2M matt blue remote wire, 0.15TCA \times 29, OD:2mm
- ▼ Fuse 80A
- ▼ Other accessories



POWER cable

NW-P0

0GA, [73/0.12CCA \times 7 \times 7]+
[10/0.15TC \times 12+10/0.15 \times 12],
OD:15MM, 20M



NW-P4

4GA, [0.12CCA \times 28 \times 7 \times 7]+
[0.15TC \times 10 \times 12+0.15 \times 10 \times 12],
OD:10MM, 30M



NW-P8

8GA, [0.12CCA \times 63 \times 7]+
[0.15TC \times 8 \times 8+0.15 \times 8 \times 8],
OD:6.5MM, 50M



SPEAKER cable

NW-S12

12GA, 7 \times 42 \times 0.12TCA \times 2C,
OD:4.5+4.5MM, 100M



NW-S16

16GA, 7 \times 16 \times 0.12TCA \times 2C,
OD:3.5+3.5MM, 100M



NW-S18

18GA, 3 \times 24 \times 0.12TCA \times 2C,
OD:3+3MM, 100M



REMOTE cable

NW-C18

18GA, 29 \times 0.15TCA, OD:2.5MM, 200M



RCA LEADS / FUSE HOLDERS

Golden Plated Metal Head

NR-R52 **5_M**

NR-RL52 **5_M** 2R to 2 Right Angled

NR-RL32 **3_M** 2R to 2 Right Angled

NR-R12 **1_M**



2R to 2 Right Angled

All RCA Leads: Wine Red Cable, [0.12x12x2+foil]x2, OD:4+4mm

Golden Plated Plastic Head

NR-P52 **5_M**

NR-P32 **3_M**

NR-P22 **2_M**

NR-PF022

22_{CM} 1M 2F RCA Connector

NR-PM022

22_{CM} 1F 2M RCA Connector

NR-P12 **1_M**

NR-P052 **0.5_M**



NF3 **60A_{x4}**

NF2 **60A_{x2}**

NF1 **60A**



- ▼ Suitable for 4GA/8GA Cable
- ▼ Nickel Plated Metals
- ▼ Resistant to High Temperatures and Anti-throw Case



www.nakamichicaraudio.com



Nakamichi Japan

www.nakamichicaraudio.com

www.nakamichiasia.com

Specifications and design may be subject to modification without notice.
Picture may vary from actual products.
Product colors and illumination may differ in photographs from actual
appearance, due to effects of printing and photography.
Printed in April, 2013

